



LOCALLY OWNED

WEST COAST Elevators



SUITE LIFT COLLECTION

WEST COAST Elevators

ABOUT US

West Coast Elevators are an Australian owned and operated company with a highly professional, motivated and friendly team who specialise in supplying the best products and services to meet the needs of the Australian industry.

We are committed to exceeding our customers expectations through custom design with complete flexibility and value for money.

Our standard lift packages come with many inclusions. We are committed to delivering affordable luxury.



MADE IN
ITALY



24h
SUPPORT



QUALITY
CONTROL

WHAT WE DO

West Coast Elevators are the exclusive Australian distributors of the Italian designed and made 'Suite Lift' range of products, which are compliant to the Australian Lift Code AS1735.

We specialise in the Supply, Installation and Maintenance of high quality Italian Residential Lifts, Low Rise Commercial Lifts and Disability Access Lifts.

West Coast will not be beaten for Quality, Flexibility, Value and Customer Service.

Our team of skilled staff have many years of experience and knowledge within the industry and are committed to assisting all of our clients with design, Installation, Service and 24hr Support.



QUALITY & LUXURY

Manufacturing your Suite Lift

The Suite Lift range of products have over 25 years of design and manufacturing experience built into them. Each lift package comprises of the latest technology resulting in the highest quality, stylish and efficient lift systems. Our supplier is committed to continuous improvement and design innovation.

The Suite Lifts are manufactured using innovative, energy efficient machinery such as the Fiber Optic Laser Cutting machine. The entire production process relies on the energy produced by a 100kw solar powered system installed at the production plant. Thanks to this, the factory is energy self sufficient, confirming our suppliers commitment to a greener future.

ECONOMIC



All Suite Lift packages come with the latest energy saving features and are qualified Class A according to the German norm VDI4707.

UNECONOMIC



European Certifications & Quality Control

Italian    *Made* 

RESIDENTIAL SUITE LIFT

Manual swing door home lift



THE INDUSTRY LEADING RESIDENTIAL SUITE LIFT

Complying to AS1735.18 - Passenger lifts for private residence



The Suite Lift is one of the most attractive and captivating home lift on the market. West Coast Elevators guarantee a minimum 300kg load rating with every Suite Lift cabin configuration as “standard” making the Suite Lift an industry leading mighty powerful home lift with manual swing landing doors. The Suite Lift cabin can be completely customised starting from 600x600mm all the way up to 1100x1400mm offering complete flexibility with design.

TECHNICAL DATA

Lift Code	AS1735.18
Cabin Size	From 600W x 600D up to 1100W x 1400D (mm)
Door Opening	From 600 up to 950 (mm)
Load Rating	300 kg - 400kg
Speed	0.30m/s
Travel	12m (Max)
Pit	120mm
Headroom	2500mm
Control Cabinet	750Wx410Dx1400H (mm)
Power	300kg – Single Phase 25amp 400kg – Single Phase 32amp



SAFETY FEATURES - PEACE OF MIND

- Battery backup & Cabin lighting in case of power failure
- Automatic return to lowest floor
- Full height light curtain protection beams across cabin entrance
- Over Load Alarm and Indicator
- Creeping Speed Feature

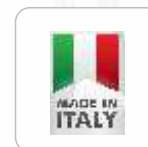

EACH SUITE LIFT PACKAGE COMES WITH THE FOLLOWING INCLUSIONS AS STANDARD:

- ✓ 300kg Load Rating
- ✓ Digital Cabin Display
- ✓ Full Height Control Operating Panel with Sleek Button Integration Design
- ✓ 4 x LED Ceiling Lights
- ✓ Full Height Flat Integrated Door Handles
- ✓ Wide Range of Luxury Skinplate Wall Finishes

AVAILABLE CABIN CONFIGURATIONS

- Single Entry in Masonry Shaft & Metal Structure
- Through Car in Masonry Shaft & Metal Structure
- Adjacent Entry in Masonry Shaft & Metal Structure



COMPLETE DESIGN FLEXIBILITY

If you are building a new home or looking to retrofit a lift into an existing home, West Coast Elevators highly skilled consultants can assist you with design, ideas and concepts to ensure you get the best product in the most suitable location.

West Coast Elevators will custom design the largest possible cabin size to suit any existing shaft or we can customize a Glazed Metal Structure to surround the lift in both indoor or outdoor applications creating a luxurious and state of the art feature.

“You will be amazed where we can incorporate a lift into any building design, minimising space and saving on builders works.”

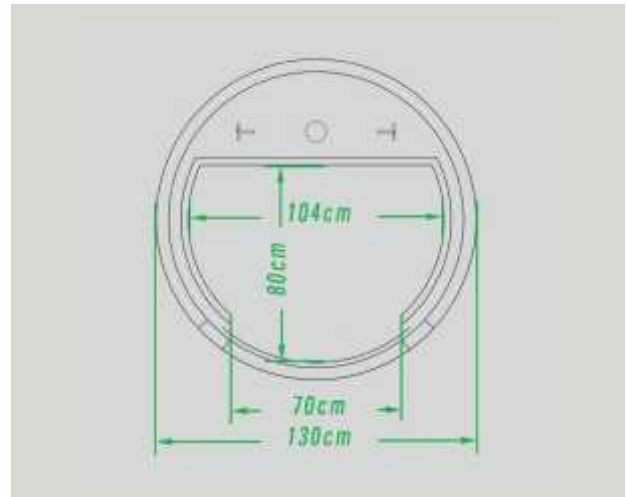
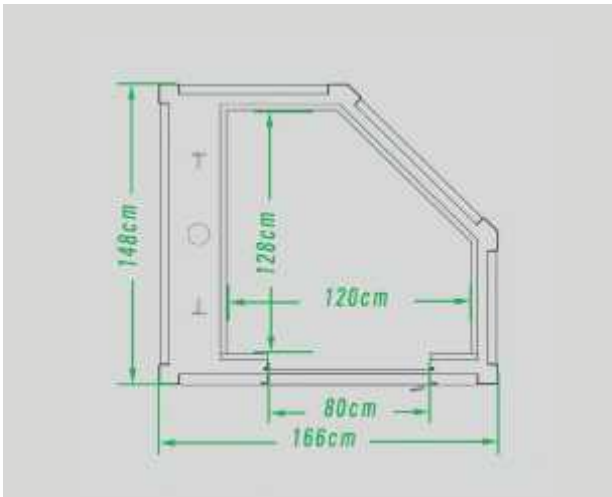

RESIDENTIAL SUITE LIFT DOOR OPTIONS



GRETA



KATE DIAMOND



MARGARET



SOPHIA (FIRE RATED)



KRISTAL



GIOTTO ROUND DOOR

RESIDENTIAL SUITE LIFT DOOR HANDLE OPTIONS



FULL HEIGHT FLAT INTEGRATED DOOR HANDLES



600MM CURVED OR STRAIGHT STAINLESS STEEL HANDLE

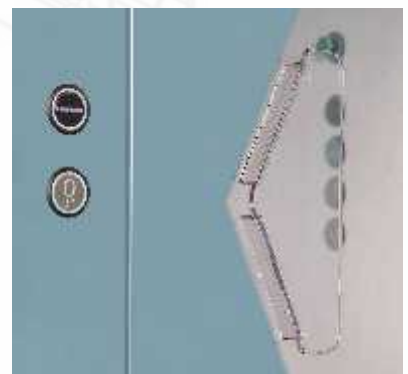

CLEAR GLASS HANDLE

RESIDENTIAL ROYAL SUITE LIFT

Luxurious automatic sliding doors



THE ULTIMATE RESIDENTIAL ROYAL SUITE LIFT

Complying to AS1735.18 Passenger lifts for private residence



The Royal Suite Lift is the pinnacle of home lifts with automatic sliding doors. Ultra smooth, quiet and reliable with excellence in design. The luxurious Royal Suite Lift comprises the finest Italian quality and style.

West Coast Elevators offers 300kg - 400kg load rating with every Royal Suite Lift cabin configuration as "standard". The Royal Suite cabin size can be completely customised ranging from 800x800mm all the way up to 1100x1400mm offering complete flexibility with design.

TECHNICAL DATA

Lift Code	AS1735.18
Cabin Size	From 800W x 800D up to 1100W x 1400D (mm)
Door Opening	From 800 up to 900 (mm)
Load Rating	300kg - 400kg
Speed	0.30m/s
Travel	12m (Max)
Pit	150mm
Headroom	2600mm
Control Cabinet	750Wx410Dx1400H (mm)
Power	Single Phase 32amp



SAFETY FEATURES - PEACE OF MIND

- Battery backup and Cabin lighting in case of power failure
- Automatic return to lowest floor
- Full height light curtain protection beams across cabin entrance
- Over Load Alarm and Indicator
- Creeping Speed Feature

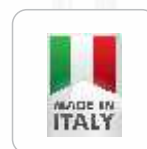

EACH ROYAL SUITE LIFT PACKAGE COMES WITH THE FOLLOWING INCLUSIONS AS STANDARD:

- ✓ Digital Cabin Display
- ✓ Full Height Control Operating Panel Sleek Button Integration Design
- ✓ 4 x LED Ceiling Lights
- ✓ Grey or Blue Separate Push Buttons
- ✓ Wide Range of Luxury Skinplate wall finishes

AVAILABLE CABIN CONFIGURATIONS

- Single Entry in Masonry Shaft & Metal Structure
- Through Car in Masonry Shaft & Metal Structure





ROYAL SUITE LIFT - CABIN AND LANDING DOOR OPTIONS



SKINPLATE OR RAL PAINTED
(STANDARD)



BRUSHED S/S



SKINPLATE OR RAL PAINTED
FRAME WITH CLEAR GLASS



CLEAR GLASS PANORAMIC

ROUND PANORAMIC SUITE LIFT

Superior Luxury



SUPERIOR LUXURY ROUND PANORAMIC SUITE LIFT

Complying to AS1735.18 - Passenger lifts for private residence

The Round Panoramic Suite Lift is the clear leader within the industry. Unique by design and accompanied by the finest details. Architects and Designers alike love the Round Panoramic Suite Lift as the preferred choice when incorporating a luxurious lift into the most prestigious homes.

The Round Panoramic Suite Lift can be completely customised to suit any curved or round space. This Lift is housed in it's own custom designed Round Glazed Metal Structure so there is no need to construct a masonry shaft.

This amazing design is the result of engineering excellence and continued design innovation.

TECHNICAL DATA

Lift Code	AS1735.18
Cabin Size	1200W x 945D (mm)
Glass Metal Structure	1540mm (diameter)
Door Opening	650mm (manual swing doors)
Load Rating	300kg
Speed	0.30m/s
Travel	12m (max)
Pit	150mm
Headroom	2500mm
Control Cabinet	AS1735.18
Power	Single Phase 25amp



SAFETY FEATURES - PEACE OF MIND

- Battery backup & Cabin lighting in case of power failure
- Automatic return to lowest floor
- Full height light curtain protection beams across cabin entrance
- Over Load Alarm and Indicator
- Creeping Speed Feature

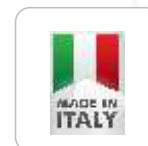

EACH SUITE LIFT PACKAGE COMES WITH THE FOLLOWING INCLUSIONS AS STANDARD:

- ✓ 300kg Load Rating
- ✓ Digital Cabin Display
- ✓ Full Height Control Operating Panel with Sleek Button Integration Design
- ✓ 4 x LED Ceiling Lights
- ✓ Clear Glass Door Handles
- ✓ Wide Range of Luxury Skinplate Wall Finishes

AVAILABLE CABIN CONFIGURATIONS

- Single Entry in Metal Structure
- Through Car in Metal Structure
- Adjacent Entry in Metal Structure



COMMERCIAL SUITE LIFT

Low rise commercial & public application



SUPERIOR QUALITY COMMERCIAL SUITE LIFT

Complying to AS1735.16/12 Lifts for persons with Limited Mobility



The Commercial Suite Lift package is Designed by West Coast Elevators specifically for low rise Commercial and Public applications. This Lift comes with all requirements of AS1735.16/12. West Coast Elevators have tailored a complete package for every Commercial Suite Lift as “standard” making the Commercial Suite Lift a superior low rise commercial lift with automatic sliding cabin and landing doors.

TECHNICAL DATA

Lift Code	AS1735.16/12
Cabin Size	1100W x 1400D (mm)
Clear Door Opening	900mm
Load Rating	400kg
Speed	0.30m/s
Travel	12m (Max)
Pit	150mm
Headroom	2600mm
Control Cabinet	750Wx410Dx1400H (mm)
Power	Single Phase 32amp



INCLUDED FEATURES

- ✓ Cabin & Landing Door Enabling Keys
- ✓ Auto Dial Telephone in Cabin
- ✓ Brushed Stainless Steel Handrail
- ✓ Brushed Stainless Steel Cabin and Landing Doors and Frames
- ✓ All Push Buttons with Braille



SAFETY FEATURES - PEACE OF MIND

- Battery Backup and Cabin Lighting in case of power failure
- Automatic return to lowest floor
- Full height light curtain protection beams across cabin entrance
- Over Load Alarm and Indicator
- Creeping Speed Feature





EACH COMMERCIAL SUITE LIFT PACKAGE COMES WITH THE FOLLOWING INCLUSIONS AS STANDARD:

- Digital Cabin Display
- Full Height Control Operating Panel
Sleek Button Integration Design
- 4 x LED Ceiling Lights
- Grey or Blue Separate Push Buttons with Braille
- Wide Range of Luxury Skinplate wall finishes

AVAILABLE CABIN CONFIGURATIONS

- Single Entry in Masonry Shaft & Metal Structure
- Through Car in Masonry Shaft & Metal Structure

COMMERCIAL SUITE LIFT CABIN AND LANDING DOOR OPTIONS



BRUSHED S/S



SKINPLATE OR RAL PAINTED FRAME WITH CLEAR GLASS



CLEAR GLASS PANORAMIC

COMMERCIAL CROWN SUITE LIFT

Superior low rise commercial & General passenger lift



ENGINEERED WITH EXCELLENCE

COMMERCIAL CROWN SUITE LIFT



Complying to AS1735.1 / 12 General Passenger Lift

The Commercial Crown Suite Lift package is designed specifically for Commercial and Public applications. This Lift comes with all the requirements of AS1735.1 / 12. Complying to the Building Code of Australia (BCA) West Coast Elevators have tailored a complete package for every Commercial Crown Suite Lift as “standard” making the Commercial Crown Suite Lift an extremely reliable General Passenger lift with automatic sliding cabin and landing doors.

TECHNICAL DATA

Lift Code	AS 1735.1 / 12
Cabin Size	1100W x 1400D (mm)
Clear Door Opening	900mm
Load Rating	630kg
Speed	0.60m/s
Travel	18m (max)
Pit	1300mm
Headroom	3300mm
Control Cabinet	810Wx400Dx2100H (mm)
Power	Three Phase 415V



INCLUDED FEATURES

- ✓ Cabin & Landing Door Enabling Keys
- ✓ Auto Dial Telephone in Cabin
- ✓ Brushed Stainless Steel Handrail
- ✓ Brushed Stainless Steel Cabin and Landing Doors and Frames
- ✓ All Push Buttons with Braille
- ✓ No lifting beams required in shaft

SAFETY FEATURES - PEACE OF MIND

- Battery Backup and Cabin Lighting in case of power failure
- Automatic return to lowest floor
- Full height light curtain protection beams across cabin entrance
- Over Load Alarm and Indicator
- Creeping Speed Feature





EACH COMMERCIAL CROWN SUITE LIFT PACKAGE COMES WITH THE FOLLOWING INCLUSIONS AS STANDARD:

- Digital Cabin Display
- Full Height Control Operating Panel
Sleek Button Integration Design
- 4 x LED Ceiling Lights
- Grey or Blue Separate Push Buttons with Braille
- Wide Range of Luxury Skinplate Wall Finishes

AVAILABLE CABIN CONFIGURATIONS

- Single Entry in Masonry Shaft & Metal Structure
- Through Car in Masonry Shaft & Metal Structure

COMMERCIAL CROWN SUITE LIFT CABIN AND LANDING DOOR OPTIONS



BRUSHED S/S



SKINPLATE OR RAL PAINTED FRAME WITH CLEAR GLASS



CLEAR GLASS PANORAMIC

CABIN FINISHES

All Suite Lift Products



CABIN FINISHES

All Suite Lift Products



WALLS

HORIZONTAL LAMINATE



ACERO OTTAWA



CILIEGIO EUROPEO



TEAK SUMATRA



ROVERE TENNESSEE



DOUGLAS ICE



DOUGLAS VANILLA



DOUGLAS



RADICA OLMO

SKINPLATE CLADDING



F12PPS

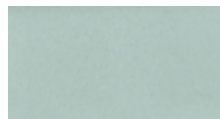

PPS12

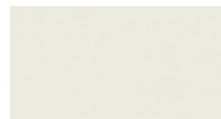

A4



N1



PPS10



B13



G1



PPS11



A13

RAL COLOURS



100's of colours to choose from.

FLOORS

PVC



GRIGO



BLUE



GHIACCIO



SABBIA



NERO

GRANITE



BIANCO



NERO



AZZURRO



VERDE ACQUA



MARRONE

ACCESSORIES

DIGITAL DISPLAYS



LANDING DOOR DIGITAL DISPLAY



CABIN DIGITAL DISPLAY

PUSH BUTTONS



GREY



BLUE

INTERIOR CABIN EXAMPLES



WALLS: A4 SKINPLATE
FLOOR: NERO GRANITE



WALLS: DOUGLAS ICE
HORIZONTAL LAMINATE
FLOOR: NERO PVC



WALLS: TEAK SUMATRA
HORIZONTAL LAMINATE
FLOOR: BIANCO GRANITE



WALLS: BRUSHED
STAINLESS STEEL
FLOOR: GHIACCIO PVC

VIRTUAL CABIN TOUR



RESIDENTIAL SUITE LIFT



SUITE LIFT
Finishes

To take a Virtual Cabin Tour visit West Coast Elevators website www.westcoastelevators.com.au

Inspect the highest quality Suite Lift Cabins today!

INTERIOR CABIN EXAMPLES



WALLS: LUXURY SKINPLATE (F12PPS)
FLOOR: GLOSSY CREAM CERAMIC TILES (provided by customer)

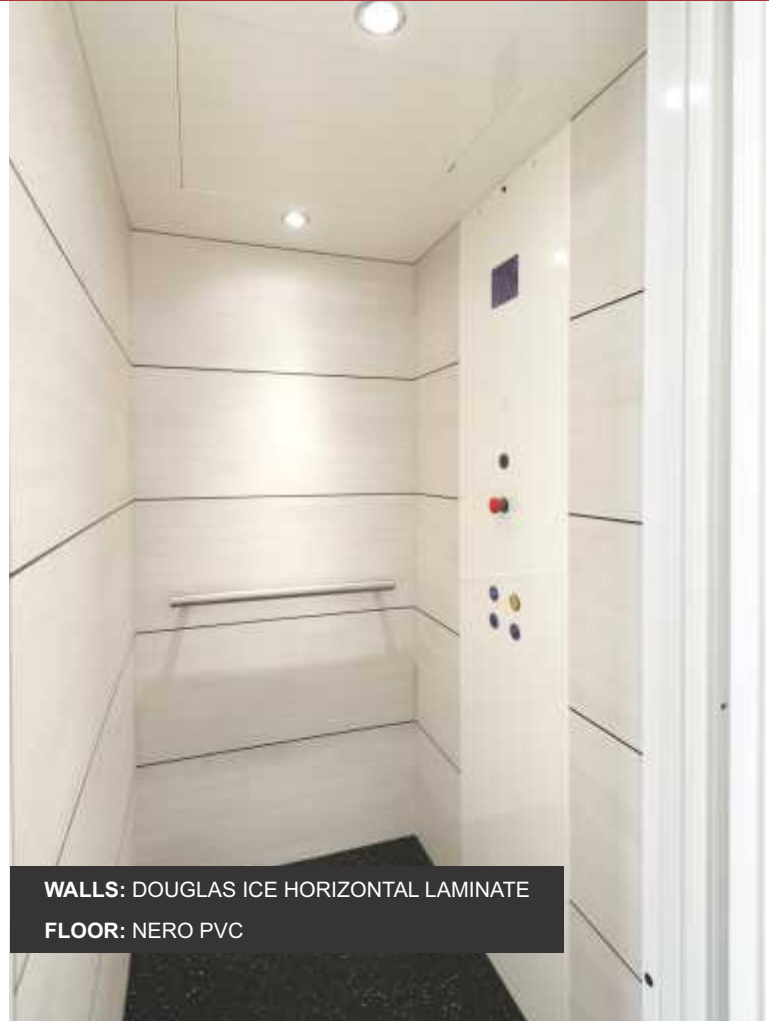

WALLS: DOUGLAS ICE HORIZONTAL LAMINATE
FLOOR: NERO PVC



WALLS: GOLD STAINLESS STEEL WALLS
WITH DARK STAIN TIMBER FLOOR



WALLS: LUXURY SKINPLATE (N1)
FLOOR: GHIACCIO PVC

INTERIOR CABIN EXAMPLES



WALLS: BRUSHED STAINLESS STEEL
FLOOR: GHIACCIO PVC



WALLS: TEAK SUMATRA HORIZONTAL LAMINATE
FLOOR: BIANCO GRANITE



WALLS: A4 SKINPLATE
FLOOR: SABBIA PVC



WALLS: SPECIAL RUSTIC METAL CLADDING
FLOOR: DARK GREY SANDSTONE TILES (provided by customer)

GLAZED METAL STRUCTURES

Suitable for indoor and outdoor applications





LUXURY DESIGN **METAL STRUCTURES**

Suitable for indoor and outdoor applications

West Coast Elevators offers a huge range of Metal Structures which are suitable for indoor and outdoor applications. The entire Suite Lift Product Range can be incorporated into a luxury Metal Structure. West Coast Elevators can even custom design a Metal Structure for you, so we guarantee the best fit design for your project.

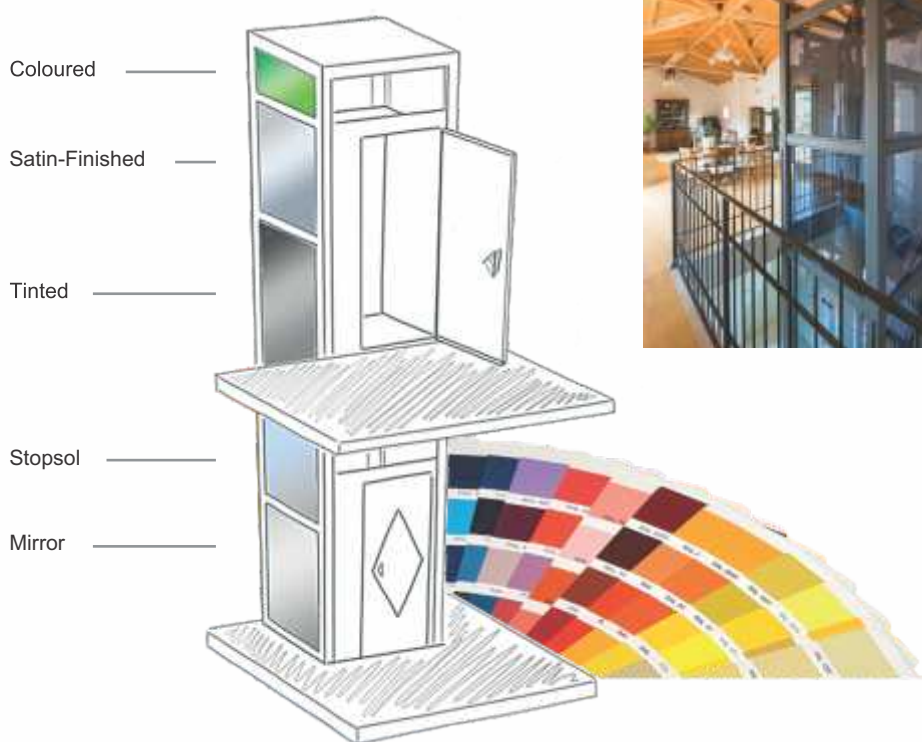

CRYSTAL MINI SUITE LIFT

Disability Access Solution



DISABILITY ACCESS CRYSTAL MINI SUITE LIFT

Complying to AS1735.14 & AS1735.15 - Low rise platforms for passengers

The sleek and efficient Crystal Mini Suite Lift is the perfect solution for Disability Access. West Coast Elevators has built this package specifically for Australia. The Crystal Mini Suite Lift platform is perfect for any environment thanks to its sleek and carefully designed configuration, which includes stainless steel frame, toughened safety glass paneling, mechanical guard system, aluminium anti slip treadplate floor, glass doors with semi automatic closing and electric lock.

Building large ramps for limited mobility access to buildings can be costly with the current gradient required for ramps, the space required can be substantive and not always achievable. The Crystal Mini Suite Lift is the perfect solution for saving space and offers immediate access to any building entrance.

Getting your certificate of occupancy is easy when you have a compliant Crystal Mini Suite Lift installed.

TECHNICAL DATA

Lift Code	AS1735.14	AS1735.15
Platform Size	1200W x 1600D (mm)	1200W x 1600D (mm)
Clear Door Opening	900mm	900mm
Load Rating	300kg - 400kg	300kg - 400kg
Controls	Constant Pressure	Constant pressure
Travel	1M (Max)	1.6M (Max)
Pit	240mm	370mm
Power	Single Phase 25amp	Single Phase 25amp

SAFETY FEATURES - PEACE OF MIND

- Emergency Battery backup in case of power failure
- Platform and Landing Door Enabling Keys
- Braille Push Buttons





WEST COAST Elevators

CONTACT US

Speak with a lift expert today

08 6263 5253

Visit our Showroom

Home Base - 55 Salvado Road,
SUBIACO WA 6008

W: www.westcoastelevators.com.au

E: info@westcoastelevators.com.au

Please contact us if you would like to make an appointment

Residential, Commercial & Disability Access Lifts